

Manual.

Step 1. Preparation.

- Before assembling your new Cuckoo Clock, prepare a working space and make sure that you have all the necessary tools at hand: scissors, pegs and glue.
- Once your working space is ready, open the packaging and lay out the contents: clock's postcard, clock's mechanism, charger, batteries, chains, pendulum and hour hands.
- You can put the mechanism parts aside and unpack the clock's postcard. In the pack you will find 1 card with Kukoledo stickers, 1 card with double-sided tape pieces, cards with cut-outs for the clock, a card with the manual (m).
- Set the manual card in front of you; It would be a good hint for further actions.

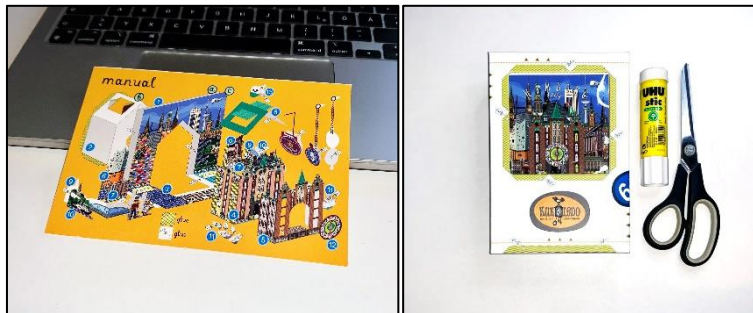

Step 2. Main body of the clock.

- Take the card ① and separate the clock background from the middle part (a). Fold it on the line.
- Separate the clock body from the card (b). Fold it on prepared lines using the instructions written on the clock body itself.
- Apply the glue to the marked areas of the clock. Connect the parts together as displayed on the manual card. Give it time to dry.
- Glue the clock body and the clock background together.
- While the main part is drying, separate the background illustration from the card (c). Fold it on the line.
- Glue the background illustration to the clock background. Let it dry.
- Separate the clock illustration from the card (d) and fold it on the lines. Remove the circular cut-out from the middle of the clock. Glue the illustration to the corresponding part of the clock body.

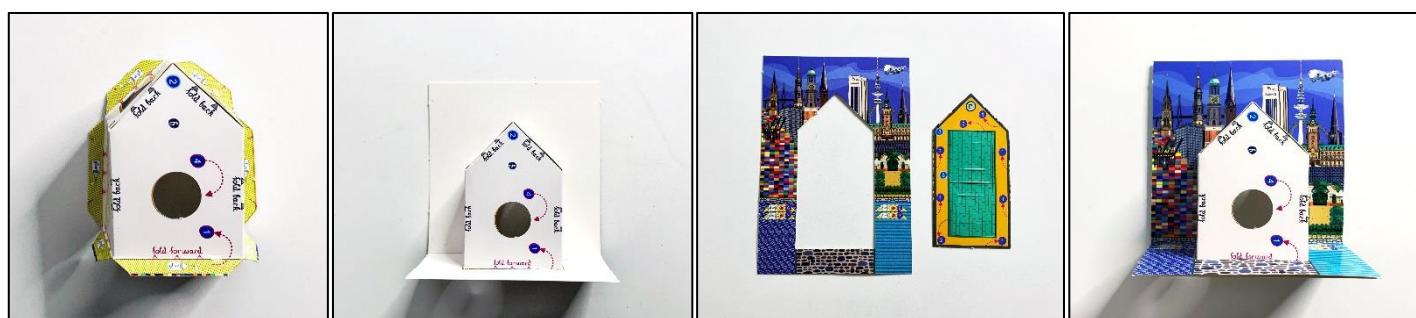
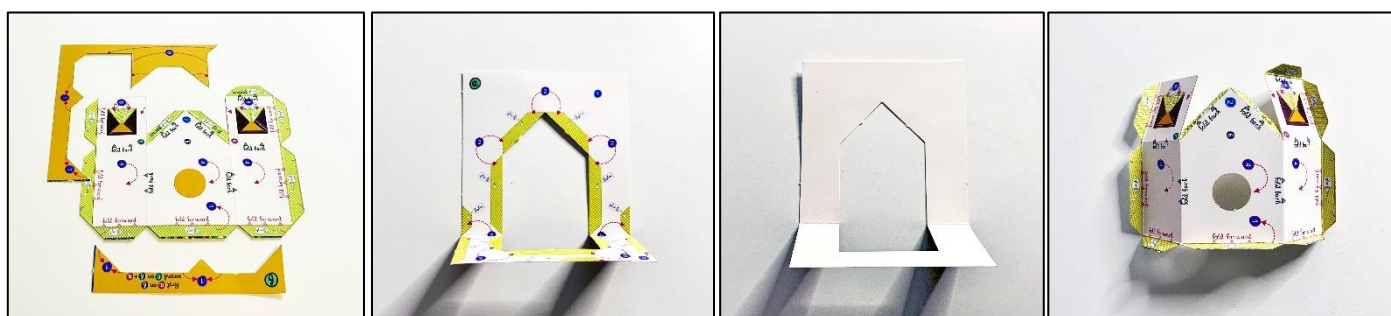

Step 3. Roof, balcony, terrace.

- Separate roof, balcony, chimney and terrace illustrations from the card (e). Fold them on the prepared lines.
- Apply the glue to the roof ridge and connect it with the roof illustration. Secure it with pegs if necessary and let it dry.
- Apply the glue to the balcony and terrace illustrations and connect them to the clock.
- Once the roof part is dry, glue it to the corresponding part of the clock body.
- Glue the chimney cut-out to the background, as shown on the manual.

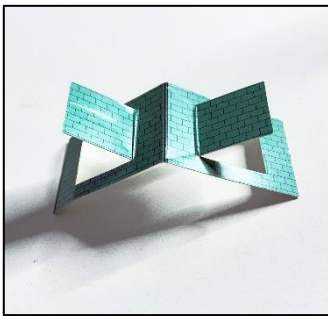

Step 4. Decorations.

- Separate the cut-outs with animals from the card (d). Fold them on the lines.
- Apply the glue to the cut-outs and connect them to the marked areas of the clock as shown on the manual. It may be easier to glue the marked parts one by one and secure the glued part with pegs or fingers while it is drying.
- Take the cut-outs with yellow marked parts from the card (f) and fold them on the lines.
- Apply the glue to the marked areas and glue them to the clock as shown on the manual card. Take into consideration that the illustrations should face towards the clock. The small triangular illustration is supposed to fit into the right bottom corner of the clock, connecting the horizontal and vertical backgrounds. The long "fence" part goes around the bottom background from the left side to the middle.
- Find the corresponding cut-outs and glue them to the external parts of the "fence" and corner triangle.
- Separate all the other cut-outs which are left on cards, except the card (a). Attention – all the additional illustrations for the clock have 2 sides: internal and external. It will be easier to place them as pairs in front of you.
- Fold all the illustrations on the prepared lines. Glue pairs together, while keeping the folded bottom parts separate, as these will be used to glue the illustrations to the clock. Give them time to dry.
- Glue the weather vane to the roof.
- Glue other illustrations to the clock as desired, or as it is shown on the manual.
- Let everything dry and enjoy the fully assembled Kukoledo Cuckoo Clock.



Step 5. Inserting the mechanism.

- Once the clock is ready, you will need all the mechanism details.
- Put the batteries into the clock mechanism.
- Separate cut-outs from the card (a). Internal and external parts are already connected. Fold them on the lines.
- Apply the glue to oval double-sided cut-outs. Connect the chain to the cut-outs and glue together.
- Apply the glue to round double-sided cut-out. Connect the pendulum to the cut-out and glue together.
- Attach double-sided tape to the clock mechanism and stick the clock body to it.
- Connect the clock face and hands to the mechanism.
- Use the dial on the back of the mechanism by pulling it out to set the clock to the correct time. Push back afterwards.
- Attach the pendulum to the bottom of the mechanism and screw in the chains to the bottom of the mechanism.

